

E-Type Actuator, Features and Benefits

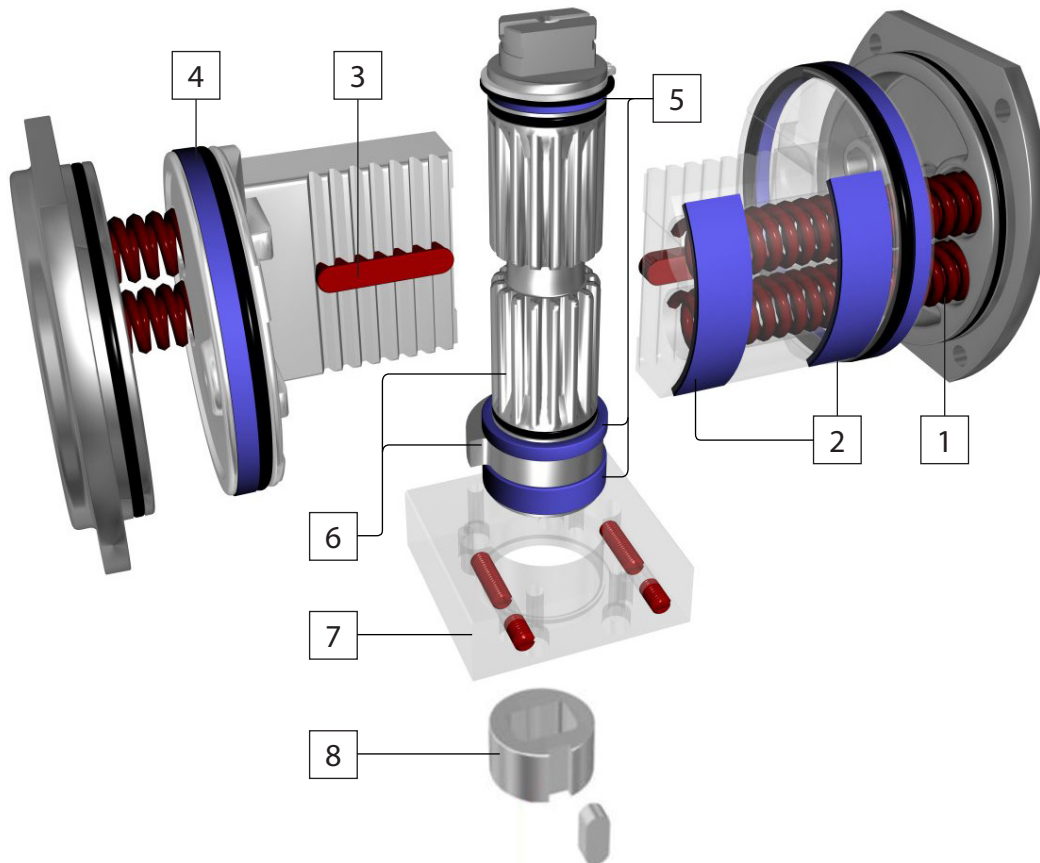

1. SPRINGS

- Springs are located inside the piston rack, same overall dimensions for DA and SR actuators.
- No special tools required to change from DA to SR or opposite.
- Long bolting is standard feature to fully relax springs.

2. PISTON WEAR PADS

- Dual encapsulated "POM" wear pads on the piston, prevent metal to metal contact between piston and cylinder, thus providing low friction travel.
- The dual encapsulated "POM" wear pads absorb the adverse side loading at start of each stroke.

3. TWIN GUIDE BARS

- Twin guide bars absorbs any adverse side loading, from rack at the start of each stroke, which reduces pinion & rack wear.

4. BACK UP BEARING

- Piston back up bearings, which are situated behind the pistons "o" ring, ensure linear movement and prevent wear on the cylinder surface.

5. TRIPPLE SHAFT BEARING

- Triple shaft bearing to prevent any adverse loading on the driveshaft

6. DRIVESHAFT & CAM

- The shaft and adjustment cam are machined from solid bar material.
- The cam mechanism allows for 2.5° over travel in both directions.
- The inner depth of the driveshaft allows for total engagement of any valve shaft height for direct mounting.

7. BODY ADAPTOR KIT

- Integral Body Adaptor Kit (BAK), interchangeable with a wide range of valves for direct mounting by using an interchangeable insert sleeve, is retained by a circlip.
- Dual end stop adjustments are integral to the body adaptor and operate in conjunction with the machined cam on a single piece driveshaft, remaining outside the pressurized cylinder.

8. INSERT SLEEVE

- Manufacture from stainless steel bar, can be rotated for cross and parallel mounting. The insert is held inside the driveshaft by means of a circlip.